

19TH & SHEPHERD

PHASE II

Houston Heights



LOCATION :	SIZE :	<p>THE HIGHEST TRAFFICKED INTERSECTION IN HOUSTON HEIGHTS</p> <p>FRONT DOOR TO THE 19TH STREET HISTORIC SHOPPING DISTRICT</p> <p>AMONGST LARGEST CLUSTER OF RETAIL IN THE HOUSTON HEIGHTS</p> <p>SHORT DRIVE TIME TO GARDEN OAKS</p> <p>UNIQUE ARCHITECTURE IN THE HEART OF THE HEIGHTS</p>
725 W. 19TH ST.	4,295 SF. BUILDING 13,100 SF. LAND	
NORTH WEST CORNER OF 19TH & SHEPHERD	TRAFFIC COUNTS:	
	35,000 CARS A DAY	

AREA TRAFFIC GENERATORS :



CONTACT **BRYAN DANNA** : PRINCIPAL

C : 832.455.4343 | O : 713.357.5800

REVIVECO.COM | BRYAN@REVIVECO.COM

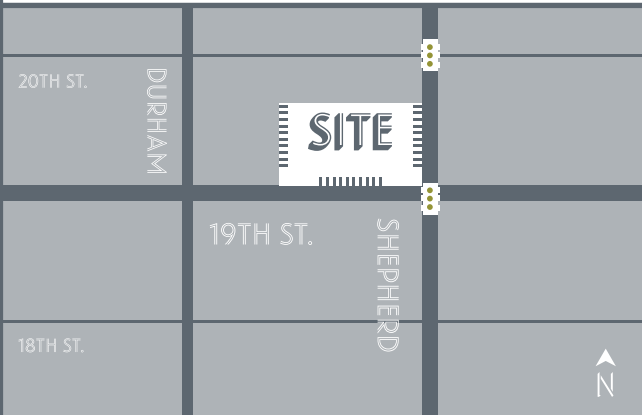

THIS IS WHAT A WIN-WIN LOOKS LIKE.

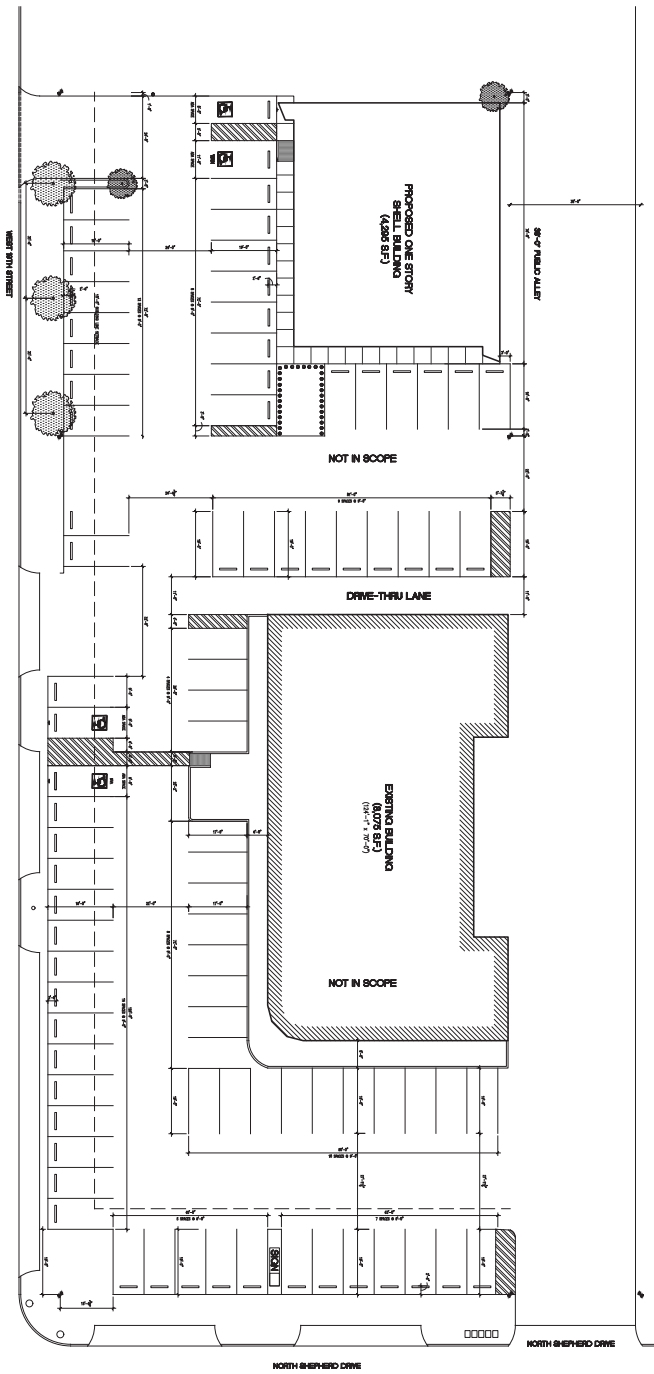

1
A1.0
SCALE: 1/8" = 1'-0"
PROPOSED SITE PLAN

- SITE A: 33 PARKING SPOTS
- 2 ADA ACCESSIBLE
- SITE B: 54 PARKING SPOTS
- 2 ADA ACCESSIBLE
- TOTAL: 87 PARKING SPOTS



<p>REVISIONS</p> <table border="1" style="width: 100%; border-collapse: collapse;"> <tr><td> </td><td> </td></tr> <tr><td> </td><td> </td></tr> <tr><td> </td><td> </td></tr> <tr><td> </td><td> </td></tr> <tr><td> </td><td> </td></tr> </table> <p>DATE ISSUED: 23 APR 2013 SHEET:</p>											<p>WEST 19TH RETAIL CENTER</p> <p>721 W 19TH STREET HOUSTON TX 77008</p>	<p>CISNEROS DESIGN STUDIO, ARCHITECTS LLC</p> <p>2500 Summer St. Suite 1220 Houston, Texas 77007 (PH) 713-520-7745 (FAX) 713-520-8884</p> <p><small>COPYRIGHT 2013 CISNEROS DESIGN STUDIO, ARCHITECTS LLC All rights reserved. No part of this publication may be reproduced, stored in a retrieval system, or transmitted, in any form or by any means, electronic, mechanical, photocopying, recording, or by any information storage and retrieval system, without the prior written permission of the publisher. The publisher shall not be liable for any damages, including consequential, special, or exemplary damages, arising out of the use of the information contained herein.</small></p>
<p>A1.0</p>	<p>NOT FOR REGULATOR APPROVAL PERMITTED OR CONSTRUCTION</p>	<p>ARCHITECT: RONALD CISNEROS ENGINEER:</p>										

REVIEW

DEVELOPMENT
SUPPLYING DEMAND

